

# MST

## 9.5" x 94.5" ACOUSTIC WOOD SLAT WALL PANEL

Making Dream Surfaces Attainable

### INSTALLATION MANUAL

#### CONTENTS

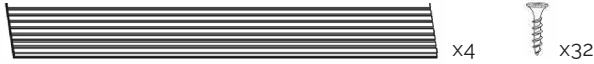

#### TOOLS NEEDED

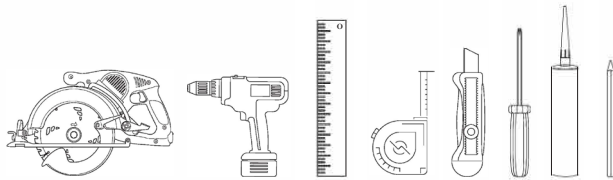

#### INSTALLATION STEPS

1. Measure the size of the installation location, the installation surface should be dry and free of mildew.

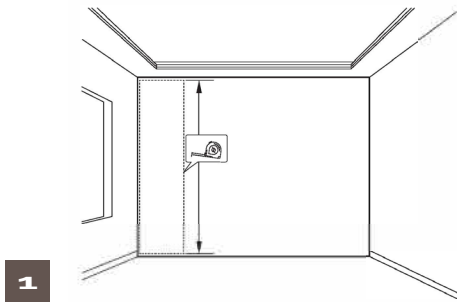

2. To install the panels on drywall, insert the appropriate anchors and/or locate the studs before drilling. Put the first panel in place and insert the screws, 8 screws per panel, space evenly around the edges.

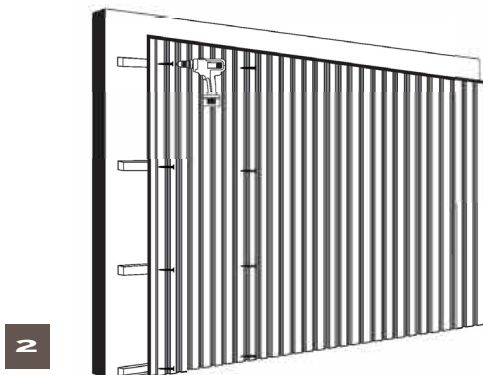

3. (Option) Our panels can be installed on walls using adhesive for a permanent installation. We recommend liquid nail Fuze-It, but any silicon-based construction adhesive will work well.

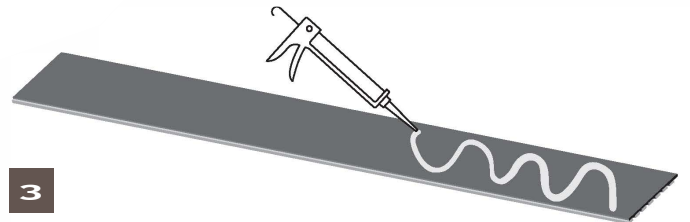

4. If you need to cut the panel cross the slats, flip the panel over, the slats facing down, cut the felt with a utility knife first. Then flip the panel back over with the slats facing upwards, use a handsaw or circular saw to cut the slats at the same place.

